

 **WB61**

Displacement sensor with  
measurement length  
up to 4,000 mm



- Protection class up to IP67/IP69
- Robust stainless steel measurement tape
- Multiple deflections possible
- With magnetic absolute encoder
- Optional with integrated inclination sensor (WBT61)
- Redundant version available

### Product versions



Analog output



Analog output, programmable



Analog output, redundant



Digital output SSI



Digital output CANopen, SAE J1939

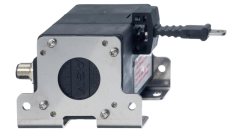

## WB61 - Tape Extension Position Sensor Version with analog output

### Specifications

		Order options
Measurement range	1500 / 2000 / 2500 / 3000 / 3500 / 4000 mm	<b>1</b> 1500 / 2000 / 2500 / 3000 / 3500 / 4000
Resolution	<0.05 mm	
Output	Voltage 0.5 ... 10 V Voltage 0.5 ... 4.5 V Current 4 ... 20 mA, 3 wire	<b>2</b> U2 U8 I1
Signal characteristics	Increasing (eg. 4 ... 20 mA) Decreasing (eg. 20 ... 4 mA)	<b>3</b> A D
Linearity	±0.10% f.s. (standard) ±0.05% f.s. (optional)	<b>4</b> L10 L05
Sensing device	Magnetic absolute encoder	
Material	PBT, stainless steel Tape: stainless steel, 10 mm wide, 0,08 mm thick	
Protection class	IP67/IP69 (with mating connector only)	
Connection	Connector M12, 5 pin	<b>5</b> M12R5
Dust wiper		<b>6</b> BAB1
Shock	DIN EN 60068-2-27:1993, 100 g/11 ms, 100 shocks	
Vibration	DIN EN 60068-2-6:2008, 20 g 10 Hz-2 kHz, 10 cycles	
Temperature range	-40 ... +85°C	
Weight	approx. 600 g with mountig brackets (140 g)	
EMC	DIN EN 61326-1:2013	

### Order code

WB61 – **1** – **2** – **3** – **4** – **5** – **6**

**Order example:** WB61 – 4000 – U2 – A – L10 – M12R5 – BAB1

### Accessories:

Connector cable (see page 18)



WB61 - Tape Extension Position Sensor  
Version with analog output, programmable

Specifications

		Order options
Measurement range	1500 / 2000 / 2500 / 3000 / 3500 / 4000 mm	<b>1</b> 1500 / 2000 / 2500 / 3000 / 3500 / 4000
Resolution	<0.05 mm	
Output	Voltage 0.5 ... 10 V, programmable Voltage 0.5 ... 4.5 V, programmable Current 4 ... 20 mA, 3 wire, programmable	<b>2</b> U2/PMU U8/PMU I1/PMU
Signal characteristics	Increasing (eg. 4 ... 20 mA) Decreasing (eg. 20 ... 4 mA)	<b>3</b> A D
Linearity	±0.10% f.s. (standard) ±0.05% f.s. (optional)	<b>4</b> L10 L05
Sensing device	Magnetic absolute encoder	
Material	PBT, stainless steel Tape: stainless steel, 10 mm wide, 0,08 mm thick	
Protection class	IP67/IP69 (with mating connector only)	
Connection	Connector M12, 5 pin	<b>5</b> M12R5
Dust wiper		<b>6</b> BAB1
Shock	DIN EN 60068-2-27:1993, 100 g/11 ms, 100 shocks	
Vibration	DIN EN 60068-2-6:2008, 20 g 10 Hz-2 kHz, 10 cycles	
Temperature range	-40 ... +85°C	
Weight	approx. 600 g with mountig brackets (140 g)	
EMC	DIN EN 61326-1:2013	

Order code

WB61	-	<b>1</b>	-	<b>2</b>	-	<b>3</b>	-	<b>4</b>	-	<b>5</b>	-	<b>6</b>
------	---	----------	---	----------	---	----------	---	----------	---	----------	---	----------

Order example: WB61 – 4000 – U2/PMU – A – L10 – M12R5 – BAB1

Accessories:

Connector cable (see page 19)

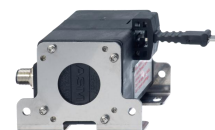

WB61 - Tape Extension Position Sensor  
**Version with analog output, redundant**

**Specifications**

		Order options
Measurement range	1500 / 2000 / 2500 / 3000 / 3500 / 4000 mm	<b>1</b> 1500 / 2000 / 2500 / 3000 / 3500 / 4000
Resolution	<0.05 mm	
Output	Voltage 0.5 ... 10 V, redundant Voltage 0.5 ... 4.5 V, redundant Current 4 ... 20 mA, 3 wire, redundant	<b>2</b> U2R U8R I1R
Signal characteristics	Output 1 increasing, output 2 increasing Output 1 increasing, output 2 decreasing Output 1 decreasing, output 2 decreasing	<b>3</b> A/A A/D D/D
Linearity	±0.10% f.s. (standard) ±0.05% f.s. (optional)	<b>4</b> L10 L05
Sensing device	Magnetic absolute encoder	
Material	PBT, stainless steel Tape: stainless steel, 10 mm wide, 0,08 mm thick	
Protection class	IP67/IP69 (with mating connector only)	
Connection	Connector M12, 8 pin	<b>5</b> M12R8
Dust wiper		<b>6</b> BAB1
Shock	DIN EN 60068-2-27:1993, 100 g/11 ms, 100 shocks	
Vibration	DIN EN 60068-2-6:2008, 20 g 10 Hz-2 kHz, 10 cycles	
Temperature range	-40 ... +85°C	
Weight	approx. 600 g with mounting brackets (140 g)	
EMC	DIN EN 61326-1:2013	

**Order code**

WB61 – **1** – **2** – **3** – **4** – **5** – **6**

**Order example:** WB61 – 4000 – I1R – A/D – L10 – M12R8 – BAB1

**Accessories:**

**Connector cable (see page 21)**



WB61 - Tape Extension Position Sensor  
Version with digital output SSI

Specifications

		Order options
Measurement range	1500 / 2000 / 2500 / 3000 / 3500 / 4000 mm	<b>1</b> 1500 / 2000 / 2500 / 3000 / 3500 / 4000
Resolution	50 µm (other resolutions on demand)	<b>2</b> 50
Output	Digital output SSI	<b>3</b> MSSSI
Linearity	±0.10% f.s. (standard) ±0.05% f.s. (optional)	<b>4</b> L10 L05
Sensing device	Magnetic absolute encoder	
Material	PBT, stainless steel Tape: stainless steel, 10 mm wide, 0,08 mm thick	
Protection class	IP67/IP69 (with mating connector only)	
Connection	Connector M12, 8 pin	<b>5</b> M12R8
Dust wiper		<b>6</b> BAB1
Shock	DIN EN 60068-2-27:1993, 100 g/11 ms, 100 shocks	
Vibration	DIN EN 60068-2-6:2008, 20 g 10 Hz-2 kHz, 10 cycles	
Temperature range	-40 ... +85°C	
Weight	approx. 600 g with mounting brackets (140 g)	
EMC	DIN EN 61326-1:2013	

Order code

WB61	-	<b>1</b>	-	<b>2</b>	-	<b>3</b>	-	<b>4</b>	-	<b>5</b>	-	<b>6</b>
------	---	----------	---	----------	---	----------	---	----------	---	----------	---	----------

Order example: WB61 – 4000 – 50 – MSSSI – L10 – M12R8 – BAB1

Accessories:

Connector cable (see page 21)

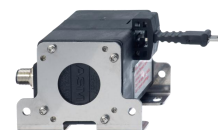

WB61 - Tape Extension Position Sensor  
Version with digital output CANopen, SAE J1939

Specifications

		Order options	
Measurement range	1500 / 2000 / 2500 / 3000 / 3500 / 4000 mm	<b>1</b>	1500 / 2000 / 2500 / 3000 / 3500 / 4000
Resolution	Setting via CAN Bus		
Output	CANopen SAE J1939	<b>2</b>	MCANOP MCANJ1939
Linearity	±0.10% f.s. (standard) ±0.05% f.s. (optional)	<b>3</b>	L10 L05
Sensing device	Magnetic absolute encoder		
Material	PBT, stainless steel Tape: stainless steel, 10 mm wide, 0,08 mm thick		
Protection class	IP67/IP69 (with mating connector only)		
Connection	Connector M12, 5 pin	<b>4</b>	M12/CAN
Dust wiper		<b>5</b>	BAB1
Shock	DIN EN 60068-2-27:1993, 100 g/11 ms, 100 shocks		
Vibration	DIN EN 60068-2-6:2008, 20 g 10 Hz-2 kHz, 10 cycles		
Temperature range	-40 ... +85°C		
Weight	approx. 600 g with mountig brackets (140 g)		
EMC	DIN EN 61326-1:2013		

Order code

WB61	-	<b>1</b>	-	<b>2</b>	-	<b>3</b>	-	<b>4</b>	-	<b>5</b>
------	---	----------	---	----------	---	----------	---	----------	---	----------

Order example: WB61 – 4000 – MCANJ1939 – L10 – M12/CAN – BAB1

Accessories:

Connector cable (see page 20)

Dimensions

WB61

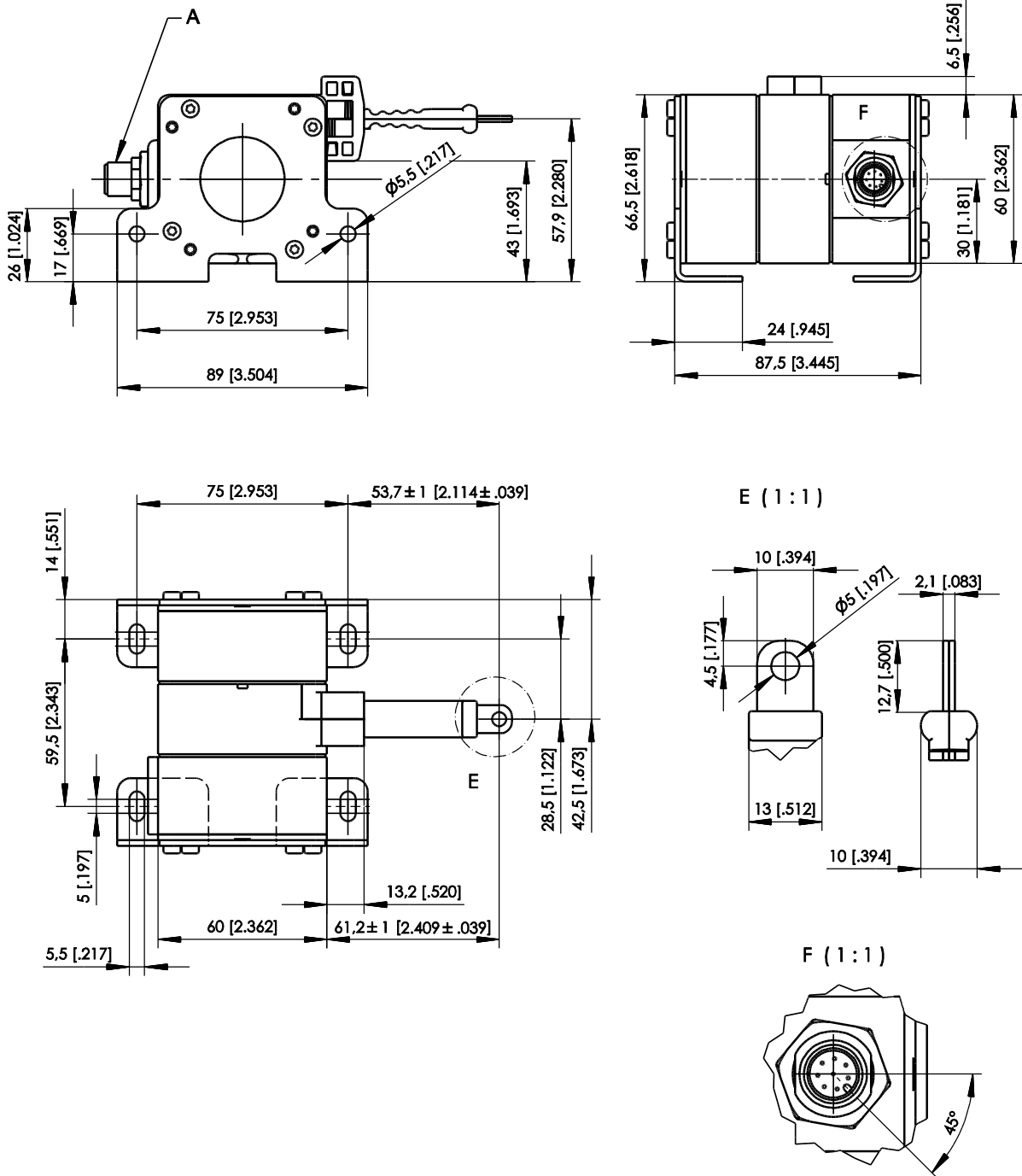

A – Connector M12

Dimensions in mm [inch]

Dimensions informative only.

For guaranteed dimensions consult factory.

## Output specification

### Analog output

<b>U2</b> Voltage output 0.5 ... 10 V 	Excitation voltage	8 ... 36 V DC
	Excitation current	20 mA typical at 24 V DC 38 mA typical at 12 V DC max. 50 mA
	Output voltage	0.5 ... 10 V DC
	Output current	2 mA max.
	Measuring rate	1 kHz standard
	Stability (temperature)	$\pm 50 \times 10^{-6}$ / °C f.s. (typical)
	Protection	Reverse polarity, short circuit
	Operating temperature	See specification of the respective sensor
	EMC	DIN EN 61326-1:2013

<b>U8</b> Voltage output 0.5 ... 4.5 V 	Excitation voltage	8 ... 36 V DC
	Excitation current	17 mA typical at 24 V DC 32 mA typical at 12 V DC 50 mA max.
	Output voltage	0.5 ... 4.5 V DC
	Output current	2 mA max.
	Measuring rate	1 kHz standard
	Stability (temperature)	$\pm 50 \times 10^{-6}$ / °C f.s. (typical)
	Protection	Reverse polarity, short circuit
	Operating temperature	See specification of the respective sensor
	EMC	DIN EN 61326-1:2013

<b>I1</b> Current output 4 ... 20 mA, 3 wires 	Excitation voltage	8 ... 36 V DC
	Excitation current	typical 36 mA at 24 V DC typical 70 mA at 12 V DC 120 mA max.
	Load R <sub>L</sub>	500 Ω max.
	Output current	4 ... 20 mA
	Measuring rate	1 kHz standard
	Stability (temperature)	$\pm 50 \times 10^{-6}$ / °C f.s. (typical)
	Protection	Reverse polarity, short circuit
	Operating temperature	See specification of the respective sensor
	EMC	DIN EN 61326-1:2013

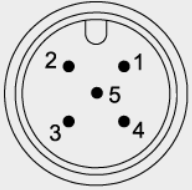

Signal wiring	Output signals	Connector pin no.	Cable color
<b>Connector M12, 5 pin</b>  View to the sensor connector	Excitation +	1	brown
	Signal	2	white
	GND	3	blue
	Do not connect!	4	black
	Do not connect!	5	(grey)

### Analog output, programmable

<b>U2/PMU</b> Voltage output 0.5 ... 10 V 	Excitation voltage	8 ... 36 V DC
	Excitation current	20 mA typical at 24 V DC 38 mA typical at 12 V DC max. 50 mA
	Output voltage	0,5 ... 10 V DC
	Output current	2 mA max.
	Measuring rate	1 kHz standard
	Stability (temperature)	$\pm 50 \times 10^{-6}$ / °C f.s. (typical)
	Protection	Reverse polarity, short circuit
	Operating temperature	See specification of the respective sensor
	EMC	EN 61326-1:2013

<b>U8/PMU</b> Voltage output 0.5 ... 4.5 V 	Excitation voltage	8 ... 36 V DC
	Excitation current	17 mA typical at 24 V DC 32 mA typical at 12 V DC max. 50 mA
	Output voltage	0.5 ... 4.5 V DC
	Output current	2 mA max.
	Measuring rate	1 kHz standard
	Stabilität (Temperatur)	$\pm 50 \times 10^{-6}$ / °C f.s. (typical)
	Protection	Reverse polarity, short circuit
	Operating temperature	See specification of the respective sensor
	EMC	DIN EN 61326-1:2013

<b>I1/PMU</b> Current output 4 ... 20 mA, 3 wires 	Excitation voltage	8 ... 36 V DC
	Excitation current	typical 36 mA at 24 V DC typical 70 mA at 12 V DC max. 120 mA
	Load $R_L$	500 $\Omega$ max.
	Output current	4 ... 20 mA
	Measuring rate	1 kHz standard
	Stability (temperature)	$\pm 50 \times 10^{-6}$ / °C f.s. (typical)
	Protection	Reverse polarity, short circuit
	Operating temperature	See specification of the respective sensor
	EMC	DIN EN 61326-1:2013

## Output .../PMU

### Programming of the start and end value by the customer (programmable)

Teach-In of start and end value for the analog outputs U2/PMU, U8/PMU, I1/PMU is provided by a binary signal SPAN/ZERO. At the start position connect signal SPAN/ZERO for a period of 2 ... 3 seconds to GND via push button. At the end position connect signal SPAN/ZERO for a period of 5 ... 6 seconds to GND via a push button. The scaling range will be stored non-volatile.

To reset the sensor to factory default ZERO/END must be connected to ground while powering up the sensor for 2 ... 3 seconds.

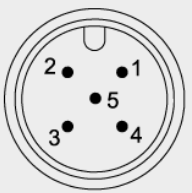
Signal wiring	Output signals	Connector pin no.	Cable color
<b>Connector M12, 5 pin</b>  View to the sensor connector	Excitation +	1	brown
	Signal	2	white
	GND	3	blue
	Do not connect!	4	black
	SPAN/ZERO	5	grey

### Analog output, redundant

<b>U2R</b> Voltage output 0.5 ... 10 V 	Excitation voltage	8 ... 36 V DC
	Excitation current	20 mA typical at 24 V DC 38 mA typical at 12 V DC max. 50 mA per channel
	Output voltage	0.5 ... 10 V DC
	Output current	2 mA max.
	Measuring rate	1 kHz standard
	Stability (temperature)	$\pm 50 \times 10^{-6}$ / °C f.s. (typical)
	Protection	Reverse polarity, short circuit
	Operating temperature	See specification of the respective sensor
	EMC	DIN EN 61326-1:2013

<b>U8R</b> Voltage output 0.5 ... 4.5 V 	Excitation voltage	8 ... 36 V DC
	Excitation current	17 mA typical at 24 V DC 32 mA typical at 12 V DC max. 50 mA per channel
	Output voltage	0.5 ... 4.5 V DC
	Output current	2 mA max.
	Measuring rate	1 kHz standard
	Stability (temperature)	$\pm 50 \times 10^{-6}$ / °C f.s. (typical)
	Protection	Reverse polarity, short circuit
	Operating temperature	See specification of the respective sensor
	EMC	DIN EN 61326-1:2013

<b>I1R</b> Current output 4 ... 20 mA, 3 wires 	Excitation voltage	8 ... 36 V DC
	Excitation current	36 mA typical at 24 V DC 76 mA typical at 12 V DC max. 120 mA per channel
	Load R <sub>L</sub>	500 Ω max.
	Output current	4 ... 20 mA
	Measuring rate	1 kHz standard
	Stability (temperature)	$\pm 50 \times 10^{-6}$ / °C f.s. (typical)
	Protection	Reverse polarity, short circuit
	Operating temperature	See specification of the respective sensor
	EMC	DIN EN 61326-1:2013

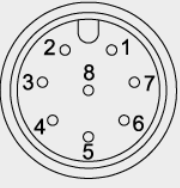
Signal wiring	Channel	Output signals	Connector pin no.	Cable color
<b>Connector M12, 8 pin</b>  View to the sensor connector	1	Excitation +	1	white
		Signal	2	brown
		GND	3	green
		Do not connect!	4	yellow
	2	Excitation +	5	grey
		Signal	6	pink
		GND	7	blue
		Do not connect!	8	red

## Digital output

<b>MSSI</b> Synchronous serial SSI 	Interface	EIA RS-422
	Excitation voltage	8 ... 36 V DC
	Excitation current	19 mA typical at 24 V DC 35 mA typical at 12 V DC max. 80 mA
	Clock frequency	100 kHz ... 500 kHz
	Code	Gray-Code, continuous progression
	Delay between pulse trains ( $t_p$ )	30 $\mu$ s min.
	Stability (temperature)	$\pm 50 \times 10^{-6}$ / °C f.s. (typical)
	Operating temperature	See specification of the respective sensor
	Protection	Reverse polarity, short circuit
	EMC	DIN EN 61326-1:2013

### Data format

(Train of 26 pulses)

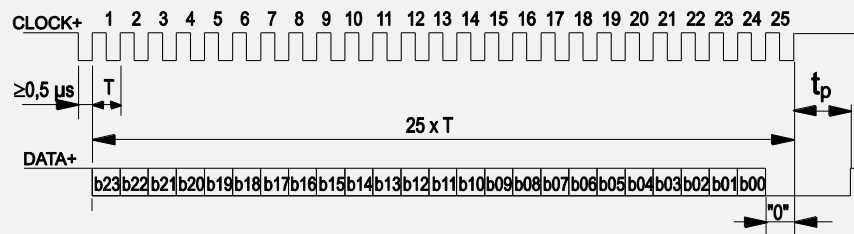

Transmission rate	Cable length	Baud rate	Note:
	50 m	100-400 kHz	Extension of the cable length will reduce the maximum transmission rate.
	100 m	100-300 kHz	

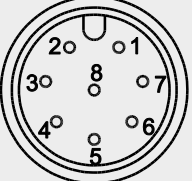
Signal wiring	Output signals	Connector pin no.	Cable color
<b>Connector M12, 8 pin</b>  View to the sensor connector	Excitation +	1	white
	Excitation GND	2	brown
	CLOCK	3	green
	$\overline{\text{CLOCK}}$	4	yellow
	DATA	5	grey
	$\overline{\text{DATA}}$	6	pink
	-	7	blue
	-	8	red

<b>MCANOP, CANOPR</b> CANopen 	CAN specification	ISO 11898, Basic and Full CAN 2.0 B
	Communication profile	CANopen CiA 301 V 4.02, Slave
	Encoder profile	Encoder CiA 406 V 3.2
	Error Control	Node Guarding, Heartbeat, Emergency Message
	Node ID	Adjustable via LSS or SDO, default: 127
	PDO	3 TxPDO, 0 RxPDO, no linking, static mapping
	PDO Modes	Event-/Time triggered, Remote-request, Sync cyclic/acyclic
	SDO	1 Server, 0 Client
	CAM	8 cams
	Certified	Yes
	Transmission rate	50 kBit bis 1 Mbit, adjustable via LSS or SDO, default: 125 kBit
	Bus connection	M12 connector, 5 pin
	Integrated bus terminating resistor	120Ω adjustable by the customer
	Bus, galvanic isolated	no

<b>Specifications</b>	Excitation voltage	8 ... 36 V DC
	Excitation current	20 mA typical at 24 V DC 40 mA typical at 12 V DC 80 mA max.
	Measuring rate	1 kHz (asynchronous)
	Stability (temperature)	±50 x 10 <sup>-6</sup> /°C f.s. (typical)
	Repeatability	1 LSB
	Operating temperature	See specification of the respective sensor
	Protection	Reverse polarity, short circuit
	Dielectric strength	1 kV (V AC, 50 Hz, 1 min.)
	EMC	EN 61326-1:2013

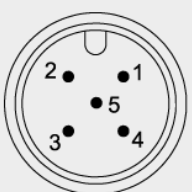
Signal wiring	Output signals	Connector pin no.	Cable color
<b>Connector M12, 5 pin</b> 	Shield	1	brown
	Excitation +	2	white
	GND	3	blue
	CAN-H	4	black
	CAN-L	5	grey

View to the sensor connector

<b>MCANJ1939</b> SAE J1939 	CAN Specification	ISO 11898, Basic and Full CAN 2.0 B
	Transceiver	24V-compliant, not isolated
	Communication profile	SAE J1939
	Baud Rate	250 kbit/s
	Internal termination resistor	120 Ω adjustable by the customer
	Address	Default 247d, configurable

<b>NAME Fields</b>	Arbitrary address capable	1	Yes
	Industry group	0	Global
	Vehicle system	7Fh (127d)	Non specific
	Vehicle system instance	0	
	Function	FFh (255d)	Non specific
	Function instance	0	
	ECU instance	0	
	Manufacturer	145h (325d)	Manufacturer ID
	Identity number	0nnn	Serial number 21 bit

<b>Parameter Group Numbers (PGN)</b>	Configuration data	PGN EF00h	Proprietary-A (PDU1 peer-to-peer)
	Process data	PGN FFnnh	Proprietary-B (PDU2 broadcast); nn Group Extension (PS) configurable

<b>Specifications</b>	Excitation voltage	8 ... 36 V DC
	Excitation current	20 mA typical at 24 V DC 40 mA typical at 12 V DC max. 80 mA
	Measuring rate	1 kHz (asynchronous)
	Stability (temperature)	±50 x 10 <sup>-6</sup> /°C f.s. (typical)
	Repeatability	1 LSB
	Operating temperature	See specification of the respective sensor
	Protection	Reverse polarity, short circuit
	Dielectric strength	1 kV (V AC, 50 Hz, 1 min.)
	EMV	EN 61326-1:2013

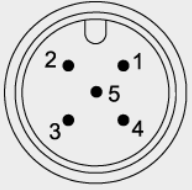

Signal wiring	Output signals	Connector pin no.	Cable color
<b>Connector M12, 5 pin</b>  View to the sensor connector	Shield	1	brown
	Excitation +	2	white
	GND	3	blue
	CAN-H	4	black
	CAN-L	5	grey

## Accessories

### Connector cable M12, 4 pin (angular coupling)

shielded connector  
Suitable for 5-pin  
sensor connectors

The 4-core screened cable is supplied with a mating 4-pin 90° M12 connector at one end and 4 wires at the other end. Available lengths are 2 m, 5 m and 10 m.  
Wire: cross sectional area 0.34 mm<sup>2</sup>  
Cable diameter: 5.6 ±0.2 mm

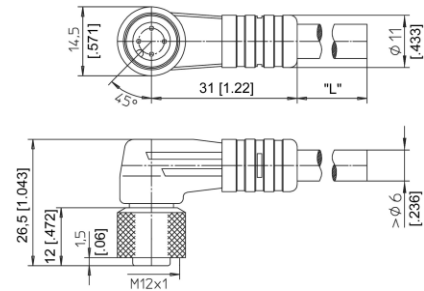

#### Order code

**KAB - xM - M12/4F/W - LITZE**

IP69: **KAB - xM - M12/4F/W/69K - LITZE**

xM = length in m

### Connector cable M12, 4 pin (straight coupling)

shielded connector  
Suitable for 5-pin  
sensor connectors

The 4-core screened cable is supplied with a mating 4-pin M12 connector at one end and 4 wires at the other end. Available lengths are 2 m, 5 m and 10 m.  
Wire: cross sectional area 0.34 mm<sup>2</sup>  
Cable diameter: 5.6 ±0.2 mm

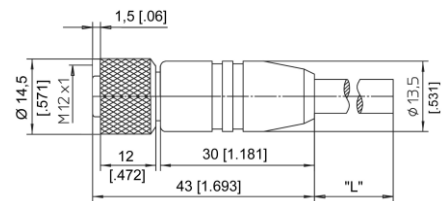

#### Order code

**KAB - xM - M12/4F/G - LITZE**

IP69: **KAB - xM - M12/4F/G/69K - LITZE**

xM = length in m

Signal wiring M12, 4 pin	Plug connection / cable color			
	1	2	3	4
	brown	white	blue	black

### Applicable for cable carriers

Maximum movement speed	3 m/s
Maximum acceleration	5 m/s <sup>2</sup>
Minimum bending radius	10 x cable diameter

## Connector cable M12, 5 pin (angular coupling)

shielded connector

The 5-core screened cable is supplied with a mating 5-pin 90° M12 connector at one end and 4 wires at the other end. Available lengths are 2 m, 5 m and 10 m.

Wire: cross sectional area 0.34 mm<sup>2</sup>

Cable diameter: 5.6 ±0.2 mm

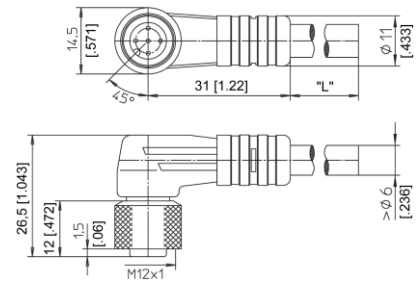

### Order code

**KAB - xM - M12/5F/W - LITZE**

IP69: **KAB - xM - M12/5F/W/69K - LITZE**

xM = length in m

## Connector cable M12, 5 pin (straight coupling)

shielded connector

The 5-core screened cable is supplied with a mating 5-pin M12 connector at one end and 4 wires at the other end. Available lengths are 2 m, 5 m and 10 m.

Wire: cross sectional area 0.34 mm<sup>2</sup>

Cable diameter: 5.6 ±0.2 mm

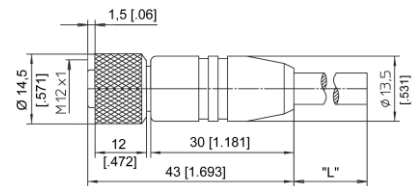

### Order code

**KAB - xM - M12/5F/G - LITZE**

IP69: **KAB - xM - M12/5F/G/69K - LITZE**

xM = length in m

Signal wiring M12, 5 pin	Plug connection / Cable color				
	1	2	3	4	5
	brown	white	blue	black	grey

### Applicable for cable carriers

Maximum movement speed	3 m/s
Maximum acceleration	5 m/s <sup>2</sup>
Minimum bending radius	10 x cable diameter

## Connector/bus cable M12, 5 pin CAN-Bus

The 5-lead shielded cable is supplied with a female 5 pin M12 connector at one end and a male 5 pin M12 connector at the other end.

Available lengths are 0.3 m, 2 m, 5 and 10 m.

Cable diameter: 6.7 ±0.2 mm

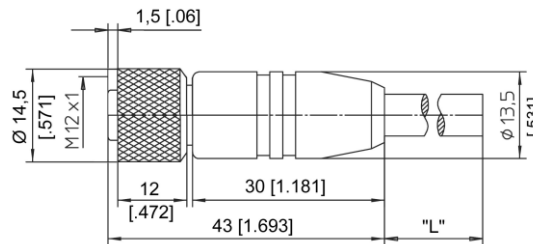

### Order code

**KAB - xM - M12/5F/G - M12/5M/G - CAN**

IP69: **KAB - xM - M12/5F/G/69K - M12/5M/G/69K - CAN**

xM = length in m

## T-connector for bus cable M12, 5 pin CAN-Bus

### Order code

**KAB - TCONN - M12/5M - 2M12/5F - CAN**



## Terminating resistor M12, 5 pin CAN-Bus

### Order code

**KAB - RTERM - M12/5M/G - CAN**



### Applicable for cable carriers

Maximum movement speed	3 m/s
Maximum acceleration	5 m/s <sup>2</sup>
Minimum bending radius	10 x cable diameter

### Connector cable M12, 8 pin (angular coupling)

shielded connector

The 8-lead shielded cable is supplied with a mating 8-pin 90° M12 connector at one end and 8 wires at the other end. Available lengths are 2 m, 5 m and 10 m.  
Wire: cross sectional area 0.25 mm<sup>2</sup>  
Cable diameter: 6.3 ±0.2 mm

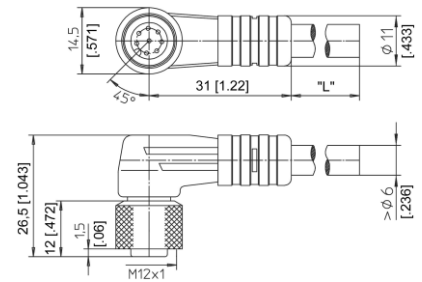

#### Order code

**KAB - xM - M12/8F/W - LITZE**

IP69: **KAB - xM - M12/8F/W/69K - LITZE**

xM = length in m

### Connector cable M12, 8 pin (straight coupling)

shielded connector

The 8-lead shielded cable is supplied with a mating 8-pin M12 connector at one end and 8 wires at the other end. Available lengths are 2 m, 5 m and 10 m.  
Wire: cross sectional area 0.25 mm<sup>2</sup>  
Cable diameter: 6.3 ±0.2 mm

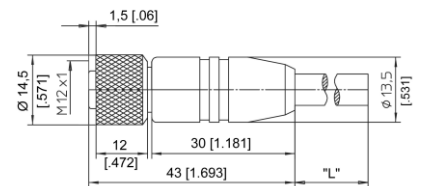

#### Order code

**KAB - xM - M12/8F/G - LITZE**

IP69: **KAB - xM - M12/8F/G/69K - LITZE**

xM = length in m

Signal wiring M12, 8 pin	Plug connection / cable color							
	1	2	3	4	5	6	7	8
	white	brown	green	yellow	grey	pink	blue	red

#### Applicable for cable carriers

Maximum movement speed	3 m/s
Maximum acceleration	5 m/s <sup>2</sup>
Minimum bending radius	10 x cable diameter

## Tape pulley WBR1

Order code: WBR1

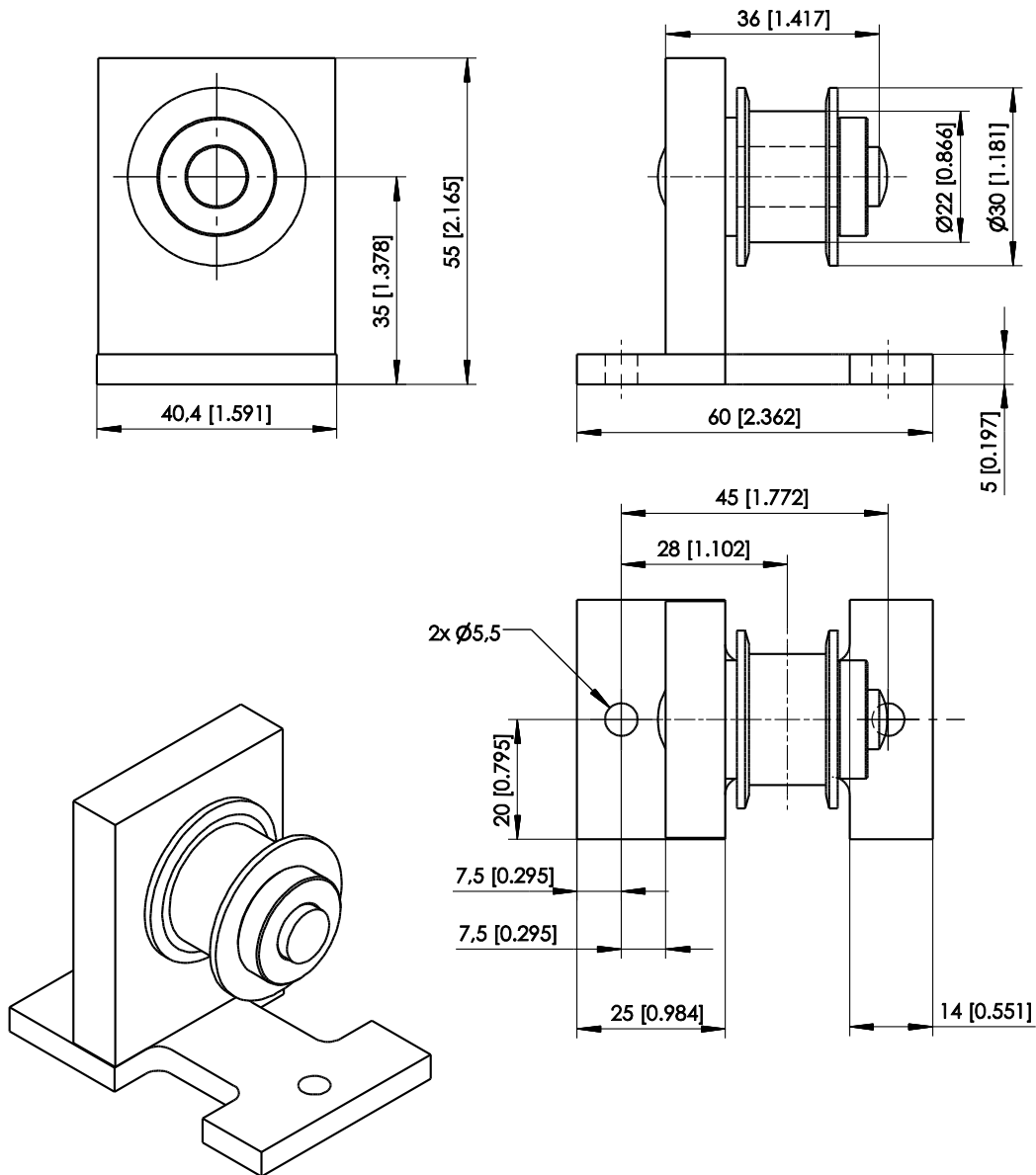

Dimensions in mm [inch]

Dimensions informative only.

For guaranteed dimensions consult factory.