

n-BMS™

Next Generation Battery Management System

The n-BMS is developed to meet all relevant automotive requirements. Featuring functionally safe design with key components such as Processor, ASIC and PSU carefully selected to meet functional safety at ASIL C level.

The “100809” monitoring unit (CMU) is compatible with both the n-BMS and the fully ISO26262 ASIL C certified n3-BMS, providing a convenient upgrade path for n-BMS users to a certified system.

The n-BMS can be configured with up to 32 CMU’s. Each CMU can monitor up to 12 cells in series and thus the n-BMS can monitor in total up to 384 cells in series. The n-BMS can measure temperature with an accuracy up to ± 1 °C.

The n-BMS uses the Creator™ software, which enables the battery designer to create a unique, application specific battery characteristics and safety strategies, while ensuring optimal performance, charge time, and overall battery life.

Highlights

Safety

- Self-test and redundancy in safety critical measurement circuits
- Open circuit detection

Usability

- RTC + logging of events, errors and warnings
- BMS Creator PC tool for easy configuration
- Optional current sensing (Hall effect or Shunt)
- CAN UDS tool

Battery Life

- High frequency sampling of current (100 mS) allows optimal detection of pulses
- Powerful and intelligent dissipative balancing at 200mA per cell
- -40° to +85°C operational range

Performance

- $\pm 1,6$ mV at 25°C at individual cell level
- ± 1 °C accuracy in temperature measurement
- Advanced SOC algorithm with OCV compensation
- Advanced SOH, SOP algorithm

Features

- Safety rated key components
- Optimized low power consumption mode
- Various 12 and 15 voltage channel cell monitoring unit (CMU) options
- ISO 26262 certification capable CMU

Applications



Next Generation Battery Management System

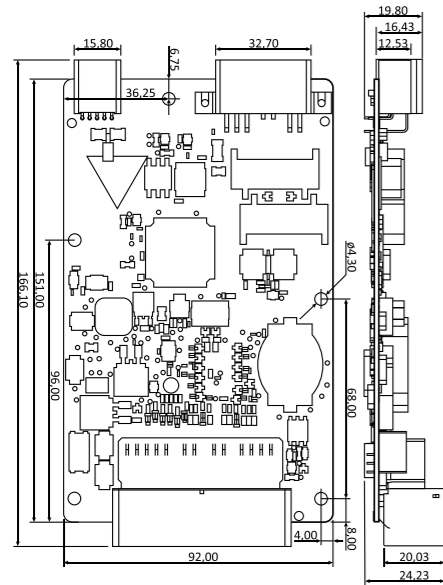

n-BMS MCU

Parameters	Specifications
Master Control Unit (MCU)	
Power supply 6-35 V	6-35 V
Number of CMU's supported	1-32
Number of cells in series for total system	384
Range of high voltage measurement	0 - 1000 VDC
Accuracy of high voltage measurement	±1 VDC
Range of current measurement input Shunt	±150 mV
Accuracy of current measurement input Shunt	±1.0 mV -40 – 85 °C
Range of current measurement input (Hall effect sensor)	0.0 – 5.0 V, 0.0 -2.5 V current in, 2.5 V – 5.0 V current out
Accuracy of current measurement input (Hall effect sensor)	±1.5 mV -40 – 85 °C
Accuracy of temperature (NTC)	±1 °C -40 – 85 °C
Ground fault detection (leakage) levels	250/500/1000 Ω/V Between GND and HV+/-
Standby Consumption	<8,5 mW at 12V supply
Active Consumption	<3,5 W at 12 V supply
Communication interface, master-slave	isoSPI
Supported CAN communication type	CAN 2.0A/B 11 bit and 29 bit IDs
Supported CAN speeds	125, 250, 500, 1000 kbit/sec
Number of CAN ports	2, one isolated CAN, one non-isolated CAN.
External GPIOs	16 (Active Low)
Charger control interfaces	CAN

Next Generation Battery Management System

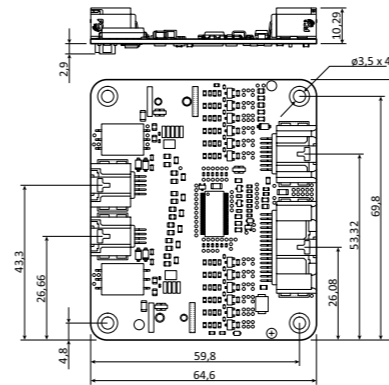

n-BMS CMU 100809

Parameters	Specifications
Cell Monitoring Unit (CMU)	
Number of cells per unit	4 - 12 Cells (minimum 12 V, to power the CMU)
Detectable cell voltage	0 - 5 VDC
Number of temperature sensors per unit	4 (NTC based)
Cell balancing topology	Dissipative
Cell balancing current	200 mA, at cell voltage 4.2 V
Cell voltage typical sampling time	100 ms
Accuracy of single cell voltage	±1,6 mV at 25 °C
Range of Temperature measurements	-40 to +85 °C
Accuracy of cell temperature (NTC)	± 2 °C -40 - 0 °C ± 1 °C 0 - 40 °C ± 2 °C 40 - 85 °C
Communication interface	isoSPI (Max. 5 m shielded cable between boards)
Standby Consumption	~460 µW (12 µA) - with 12 cells @ 3,2 V
Active Consumption	~690 mW (18 mA) - with 12 cells @ 3,2 V
Patents	ZT 200780048774, EP 0781788.6, US 8.350.529

Datasheets provided by Sensata Technologies, Inc., its subsidiaries and/or affiliates ("Sensata") are solely intended to assist third parties ("Buyers") who are developing systems that incorporate Sensata products (also referred to herein as "components"). Buyer understands and agrees that Buyer remains responsible for using its independent analysis, valuation, and judgment in designing Buyer's systems and products. Sensata datasheets have been created using standard laboratory conditions and engineering practices. Sensata has not conducted any testing other than that specifically described in the published documentation for a particular datasheet. Sensata may make corrections, enhancements, improvements, and other changes to its datasheets or components without notice. Buyers are authorized to use Sensata datasheets with the Sensata component(s) identified in each particular datasheet. HOWEVER, NO OTHER LICENSE, EXPRESS OR IMPLIED, BY ESTOPPEL OR OTHERWISE TO ANY OTHER SENSATA INTELLECTUAL PROPERTY RIGHT, AND NO LICENSE TO ANY THIRD PARTY TECHNOLOGY OR INTELLECTUAL PROPERTY RIGHT, IS GRANTED HEREIN. SENSATA DATASHEETS ARE PROVIDED "AS IS". SENSATA MAKES NO WARRANTIES OR REPRESENTATIONS WITH REGARD TO THE DATASHEETS OR USE OF THE DATASHEETS, EXPRESS, IMPLIED, OR STATUTORY, INCLUDING ACCURACY OR COMPLETENESS. SENSATA DISCLAIMS ANY WARRANTY OF TITLE AND ANY IMPLIED WARRANTIES OF MERCHANTABILITY, FITNESS FOR A PARTICULAR PURPOSE, QUIET ENJOYMENT, QUIET POSSESSION, AND NON-INFRINGEMENT OF ANY THIRD PARTY INTELLECTUAL PROPERTY RIGHTS WITH REGARD TO SENSATA DATASHEETS OR USE THEREOF. All products are sold subject to Sensata's terms and conditions of sale supplied at www.sensata.com. SENSATA ASSUMES NO LIABILITY FOR APPLICATIONS ASSISTANCE OR THE DESIGN OF BUYERS' PRODUCTS. BUYER ACKNOWLEDGES AND AGREES THAT IT IS SOLELY RESPONSIBLE FOR COMPLIANCE WITH ALL LEGAL, REGULATORY, AND SAFETY-RELATED REQUIREMENTS CONCERNING ITS PRODUCTS, AND ANY USE OF SENSATA COMPONENTS IN ITS APPLICATIONS, NOTWITHSTANDING ANY APPLICATIONS-RELATED INFORMATION OR SUPPORT THAT MAY BE PROVIDED BY SENSATA. Mailing Address: Sensata Technologies, Inc., 529 Pleasant Street, Attleboro, MA 02703, USA

Sensata Technologies Denmark A/S
Greater Copenhagen
Phone: +45 5851 5104
Email: lb_contact@sensata.com

Sensata Technologies United States of America
Attleboro, MA
Phone: 508-236-3800
Email: support@sensata.com

Sensata Technologies Holland B.V.
Hengelo
Phone: +31 74 357 8000
Email: support@sensata.com

Regional head offices:
China
Sensata Technologies China Co., Ltd.
Shanghai
Phone: +8621 2306 1500
Email: support@sensata.com

Netherlands

sensata.com